



EGGW | Universal Gateway



Quick Guide

Ver. 6.3
Release date: VII 2024
Soft:
MCU: v1.1.6
ZigBee: v1.1.9

Works with

Powered By

Available on the

UK CE ENE

Producer:
Engo Controls sp. z o.o. sp. k.
Rolna 4
43-262 Kobielice
Poland

Introduction

EGGW is the main component needed to build a smart home system based on devices that will communicate using the ZigBee 3.0 data transmission protocol. The gateway collects data from all sensors, thermostats, actuators and other smart home system components connected to it. It is also responsible for the stability of the rules and created scenarios in the ZigBee network, even when there is no Internet access temporarily. The EGGW universal gateway connects to the Internet (router) via a 2.4GHz Wi-Fi network. The gateway is compatible with the ENGO Smart application, where it is possible to make connections between ZigBee devices and Wi-Fi devices (compatible with the application) and create mutual scenarios.

CAUTION: related devices communicating in the ZigBee standard will work without Internet access.

Product features:

- ZigBee 3.0 communication standard
- Wi-Fi 2.4 GHz communication standard
- compatibility with the application ENGO Smart (in technology Tuya Cloud)
- LEDs indicating operation status

Product Compliance

This product complies with the following EU Directives: 2014/53/EU i 2011/65/EU.

Installation:

Installation must be performed by a qualified person with appropriate electrical qualifications, in accordance with the standards and regulations in force in a given country and in the EU. The manufacturer is not responsible for non-compliance with the instructions.

WARNING:

For the entire installation, there may be additional protection requirements, which the installer is responsible for.

Explanation for LED indicator

WiFi and Internet status	Red LED	Green LED	Device status
WiFi ON Internet ON	lights up	lights up	Right after switching the device on or after a factory reset, both LEDs light up for a few seconds
	LED flashes slowly	lights up	Few seconds after turning the device on, the gate is ready for pairing with the application
	lights up	lights up	Gateway is paired with the app (green LED lights up for 2 seconds and goes out)
	lights up	LED is off	Connected to cloud and WiFi
	lights up	LED flashes	The ZigBee network is open - scanning for new devices
WiFi OFF Internet OFF	LED is off	LED is off	No connection to the cloud and wifi or gateway is not connected to power supply
	LED is off	LED flashes	ZigBee network is open - scanning for new devices can be added to the gateway but they will be available in the application after restoring Wifi and Internet connection
WiFi ON Internet OFF	lights up	LED is off	No connection to the Cloud
	lights up	LED flashes	ZigBee network is open - scanning for new devices, devices can be added to the gateway but they will be available in the application after restoring Internet connection
No power supply	LED is off	LED is off	No power supply

EGGW installation

WARNING:

A minimum distance between the router and EGGW gateway of 1.5m is recommended to avoid WiFi and Zigbee interference.



WARNING:

Connect the EGGW universal gateway to a 230V AC power supply, use the supplied plug and USB cable only.

Technical specification

Power supply	5V DC micro USB
Communication	ZigBee 3.0 2,4GHz Wi-Fi 2,4GHz
Dimensions	72 x 72 x 21 mm

SAFETY INFORMATION

Use in accordance with national and EU regulations. Use the device only as intended, keeping it in a dry condition. The product is for indoor use only. Please read the entire manual, before installation or use.

Installation of the gateway in the app

Make sure your router is within range of your smartphone. Make sure you are connected to the Internet. This will reduce the pairing time of the device.

STEP 1 - DOWNLOAD ENGO SMART APP

Download the ENGO Smart app from Google Play or Apple App Store and install it on your smartphone.



STEP 2 - REGISTER THE NEW ACCOUNT

To register a new account, please follow the steps below:

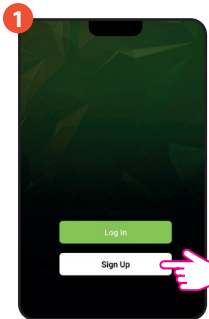

Click „Sign Up” to create new account.

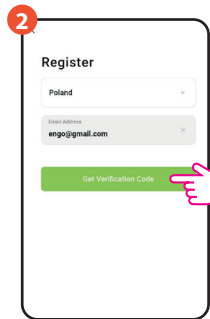

Enter your e-mail address to which the verification code will be sent.

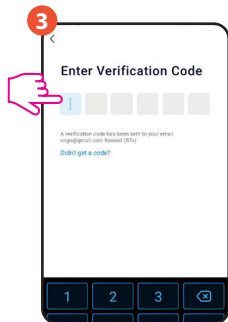

Enter the verification code received in the email. Remember that you only have 60 seconds to enter the code!

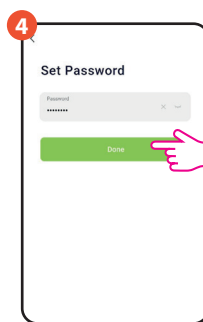

Then set the login password.

STEP 3 - CONNECT THE GATEWAY TO WI-FI

After installing the app and creating an account:

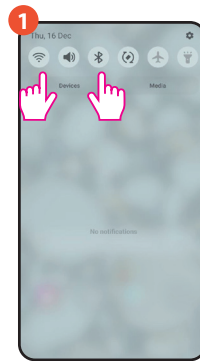

On your mobile device, make sure the ENGO Smart has access to permissions (Location, Bluetooth, Nearby devices). Then turn on Bluetooth and Location. Connect to 2.4GHz Wi-Fi network to which you want to assign the device.



Make sure the gateway is powered on. Using the PIN included, press and hold the RESET button for 10 seconds until LEDs start lighting up. The pairing mode is enabled.

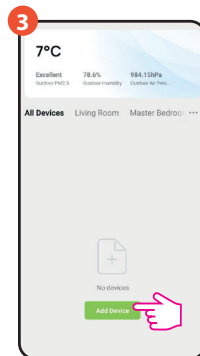

In the app, select „Add Device”.

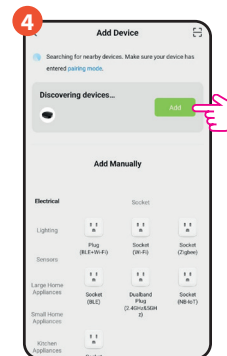

After finding the gateway, go „Add”.

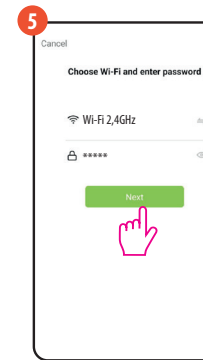

Select the Wi-Fi network in which the gateway will operate and enter the password of this network.



Wait for the app to configure the device with the selected Wi-Fi network.



Go „DONE”.

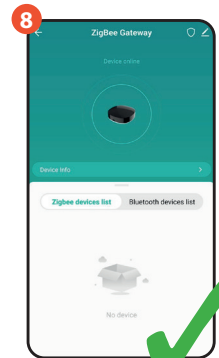

The gateway has been installed and displays the main interface.

Reset the gateway

To restore the default settings of the device, press RESET button and hold it for about 10 seconds - until both LEDs light up. The Universal Internet Gateway will then reset to the default (factory) settings and the pairing process will begin.

